

Published and correct as at 24 January 2022

If a service is utilising air purifiers, this fact sheet provides summary guidance for room placement.

Air purifiers do not replace natural and mechanical ventilation methods but complement them. Air purifiers are recommended for use in higher risk conditions including areas where high levels of mixing of staff and reduced mask use when eating, higher levels of exertion and increased aerosol projection, and areas of lower ventilation and possible exposure to illness. Some examples include staff rooms and learning areas with limited ventilation.

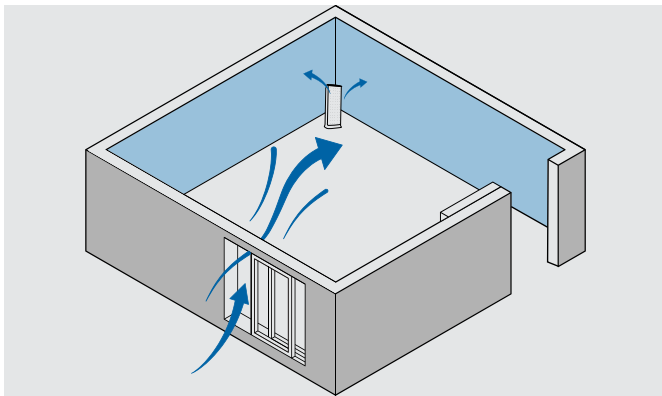

- Place the air purifiers away from open doors and windows or in areas with low air movement.

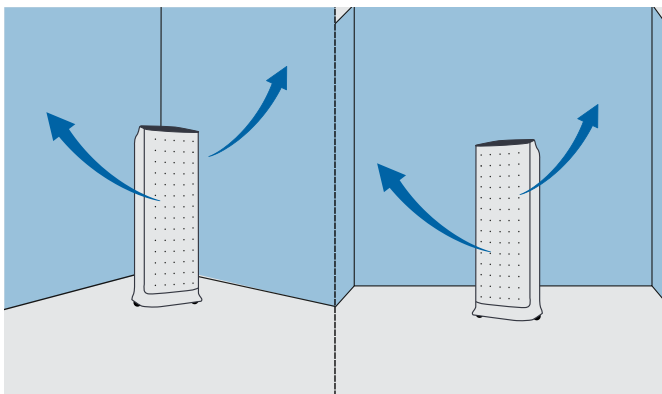

- Purifiers draw air in from the front, so you can place them against a wall.
- You can also place a purifier in a corner with 20-30cm space around the sides and the back.

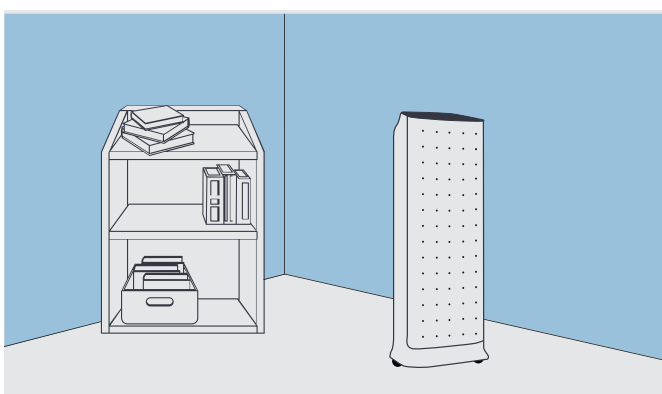

- Air purifiers are portable and can be moved to where they are considered most necessary.